

PREPARATION FOR USE

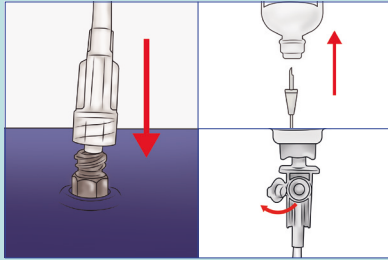

STEP 1: Connect a sterile water reservoir to the device using the inlet line. Open the side vent on the inlet line's spike.

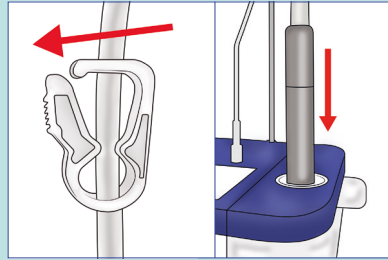

STEP 2: Insert the handpiece in the disinfection chamber and press the PRIMING button.

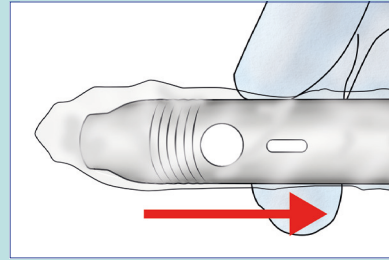

STEP 3: Cover the handpiece with a new protective barrier sleeve.

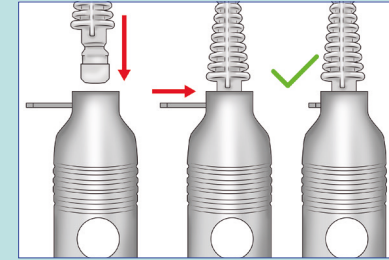

STEP 4: Attach the OdneClean Tip to the handpiece and secure it with the retention clip.

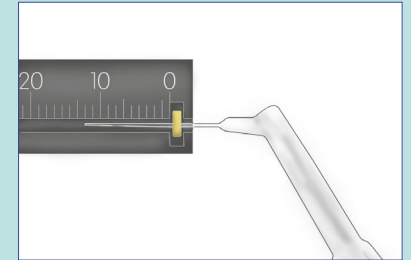

STEP 5: Position the rubber stopper on the OdneClean Tip 3 mm short of the root canal length.

OPERATION

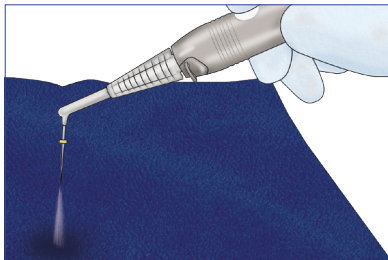

STEP 1: To verify its correct functioning, briefly activate the device outside the patient's mouth by pressing the handpiece button.

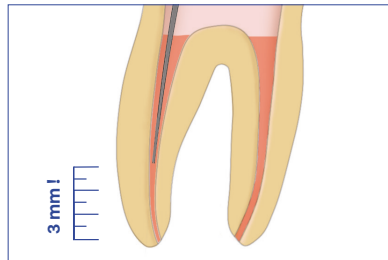

STEP 2: Insert the OdneClean Tip inside the root canal.



1 CLICK = 30s

STEP 3: Press the handpiece button once to start a 30 seconds cycle. (See IFU for operating modes).

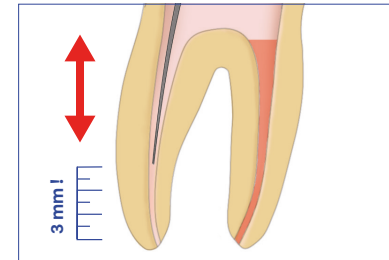

STEP 4: Gently move the tip in a pecking motion inside the canal. Ensure that the tip remains 3 mm away from the apex at all times.

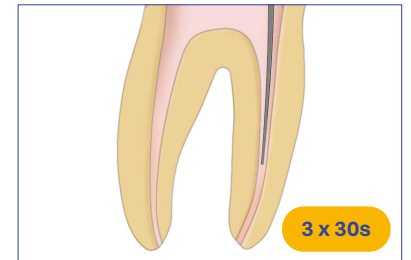

3 x 30s

STEP 5: Perform 3 x 30 seconds cycles in each root canal that requires treatment following steps 2 to 4.

AFTER USE

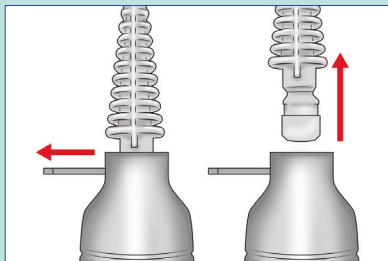

STEP 1: Pull the retention clip into the release position and remove the OdneClean Tip from the handpiece.

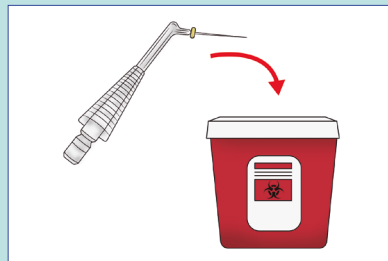

STEP 2: Dispose of the tip.

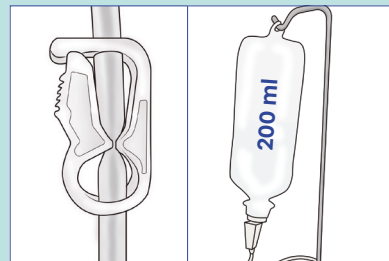

STEP 3: Check if the reservoir contains at least 200 ml of solution. Otherwise replace it.

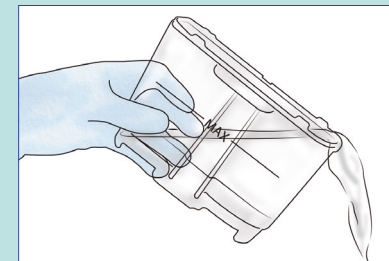

STEP 4: EMPTY the waste container and RINSE it with water.

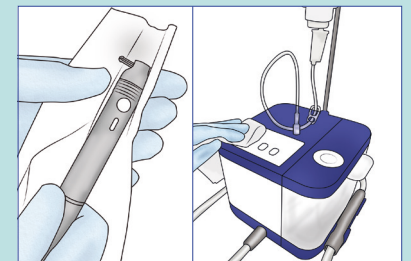

STEP 5: Clean and disinfect all the surfaces according to Chapters 5.2 and 5.3 of the IFU.

DISINFECTION (DAILY)

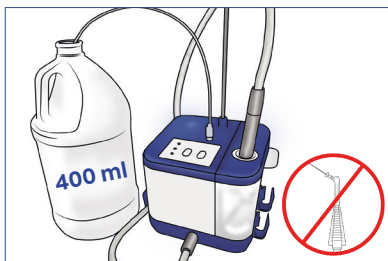

STEP 1: Place the handpiece without the tip into the disinfection chamber. Connect a bottle of disinfectant with at least 400 ml (14 FL OZ).

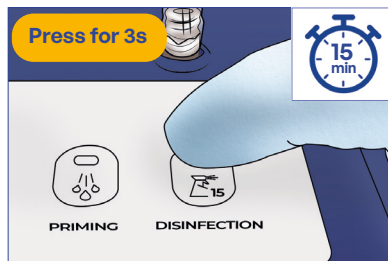

STEP 2: Press the DISINFECTION BUTTON for at least 3 seconds. Wait 15 minutes.

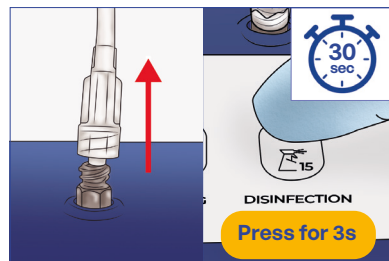

STEP 3: Disconnect the disinfectant hose and press the DISINFECTION button for at least 3 seconds.

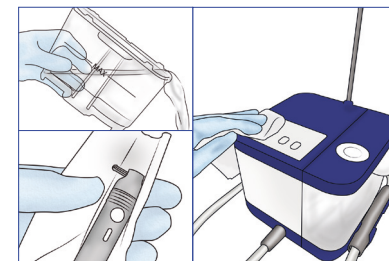

STEP 4: Clean and disinfect all the surfaces according to Chapters 5.2 and 5.3 of the IFU.

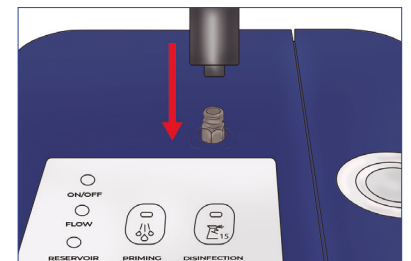

STEP 5: Place the disinfected cap on the inlet port.

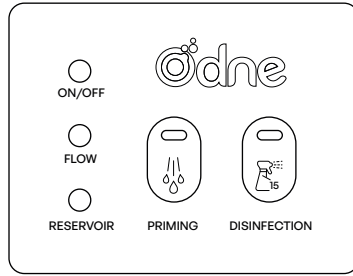

L-0043_V2.0

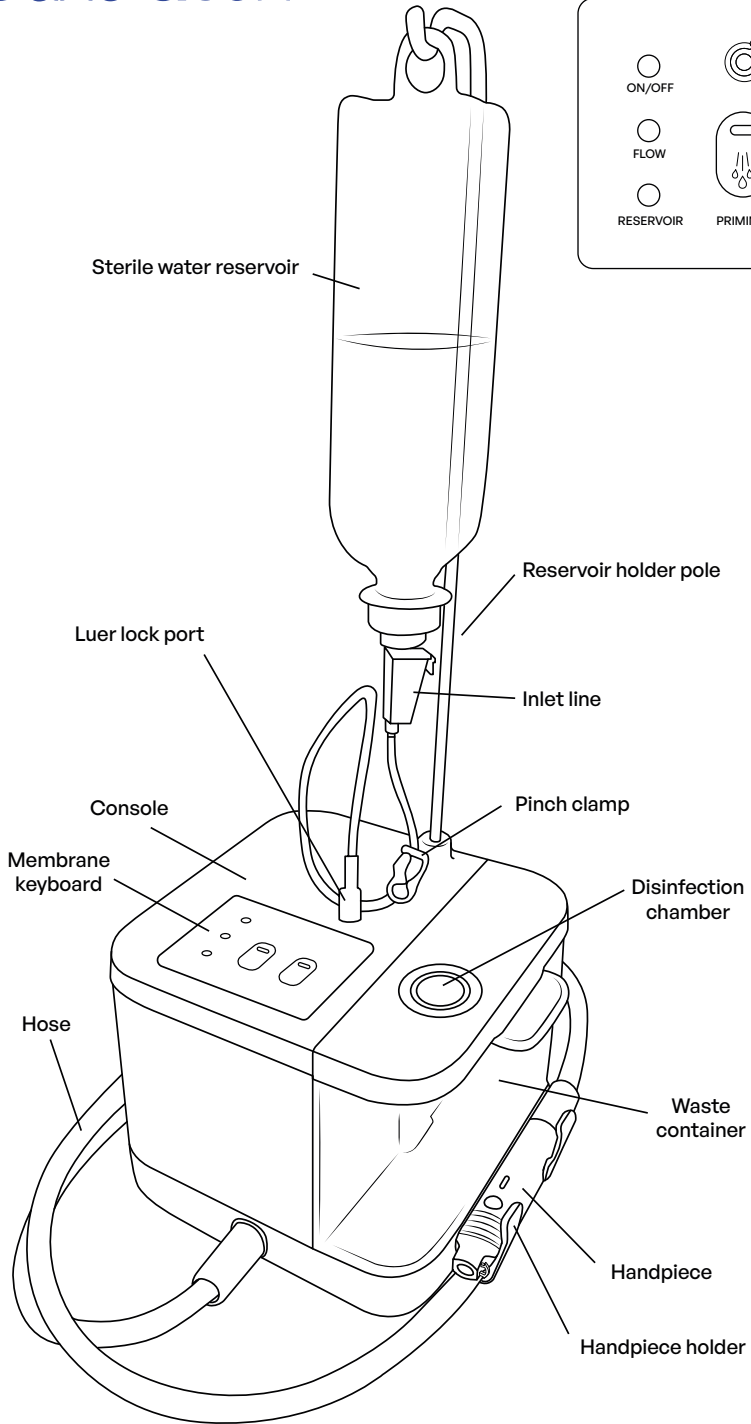

Icon	Led Color	Audio	Meaning	Solution	
ON/OFF	Green		-	The device is powered on.	-
Flow	Steady Blue		-	The "30 seconds" treatment mode is active.	-
	Flashing Blue		-	The "Continuous" treatment mode is active.	-
	Red		3 fast beeps	During treatment: blocked or broken tip. During priming or disinfection: Attached tip.	Stop treatment. Retrieve and replace the tip. Remove the tip.
Reservoir	Steady Orange		3 slow beeps	Pinch clamp closed or empty fluid reservoir.	Open the clamp or replace the reservoir. If the error persists, contact the manufacturer.
Priming	Steady Orange		-	The priming mode is active.	-
	Flashing Orange		-	Priming required before the device can be used.	Perform a priming sequence.
	Flashing Orange (after Red Flow LED)		3 fast beeps	The tip is attached.	Remove the tip. Re-start the priming sequence.
Disinfection	Steady Orange		-	The disinfection mode is active.	-
	Flashing Orange		-	Waiting to flush the disinfectant out of the system.	Disconnect the disinfectant hose and bottle, and press the button again.
	Flashing Orange (after Red Flow LED)		3 fast beeps	The tip is attached.	Remove the tip. Re-start the disinfection sequence.

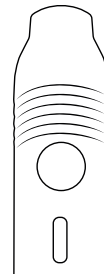

Led Color	Audio	Meaning	Solution	
Steady Blue		-	The "30 seconds" treatment mode is active.	-
Flashing Blue		-	The "Continuous" treatment mode is active.	-
Red		3 fast beeps	Blocked or broken tip.	Stop treatment. Retrieve and replace the tip.